

DETAILS

PHMS

106, 108, 110, 113, 116, 206, 208,
210, 213, 213NC, 216, 216NC

Алматы (7273)495-231
Архангельск (8182)63-90-72
Астрахань (8512)99-46-04
Барнаул (3852)73-04-60
Белгород (4722)40-23-64
Брянск (4832)59-03-52
Владивосток (423)249-28-31
Волгоград (844)278-03-48
Вологда (8172)26-41-59
Воронеж (473)204-51-73
Екатеринбург (343)384-55-89
Иваново (4932)77-34-06

Ижевск (3412)26-03-58
Иркутск (395)279-98-46
Казань (843)206-01-48
Калининград (4012)72-03-81
Калуга (4842)92-23-67
Кемерово (3842)65-04-62
Киров (8332)68-02-04
Краснодар (861)203-40-90
Красноярск (391)204-63-61
Курск (4712)77-13-04
Липецк (4742)52-20-81

Магнитогорск (3519)55-03-13
Москва (495)268-04-70
Мурманск (8152)59-64-93
Набережные Челны (8552)20-53-41
Нижний Новгород (831)429-08-12
Новокузнецк (3843)20-46-81
Новосибирск (383)227-86-73
Омск (3812)21-46-40
Орел (4862)44-53-42
Оренбург (3532)37-68-04
Пенза (8412)22-31-16

Пермь (342)205-81-47
Ростов-на-Дону (863)308-18-15
Рязань (4912)46-61-64
Самара (846)206-03-16
Санкт-Петербург (812)309-46-40
Саратов (845)249-38-78
Севастополь (8692)22-31-93
Симферополь (3652)67-13-56
Смоленск (4812)29-41-54
Сочи (862)225-72-31
Ставрополь (8652)20-65-13

Сургут (3462)77-98-35
Тверь (4822)63-31-35
Томск (3822)98-41-53
Тула (4872)74-02-29
Тюмень (3452)66-21-18
Ульяновск (8422)24-23-59
Уфа (347)229-48-12
Хабаровск (4212)92-98-04
Челябинск (351)202-03-61
Череповец (8202)49-02-64
Ярославль (4852)69-52-93

Киргизия (996)312-96-26-47

Россия (495)268-04-70

Казахстан (7172)727-132

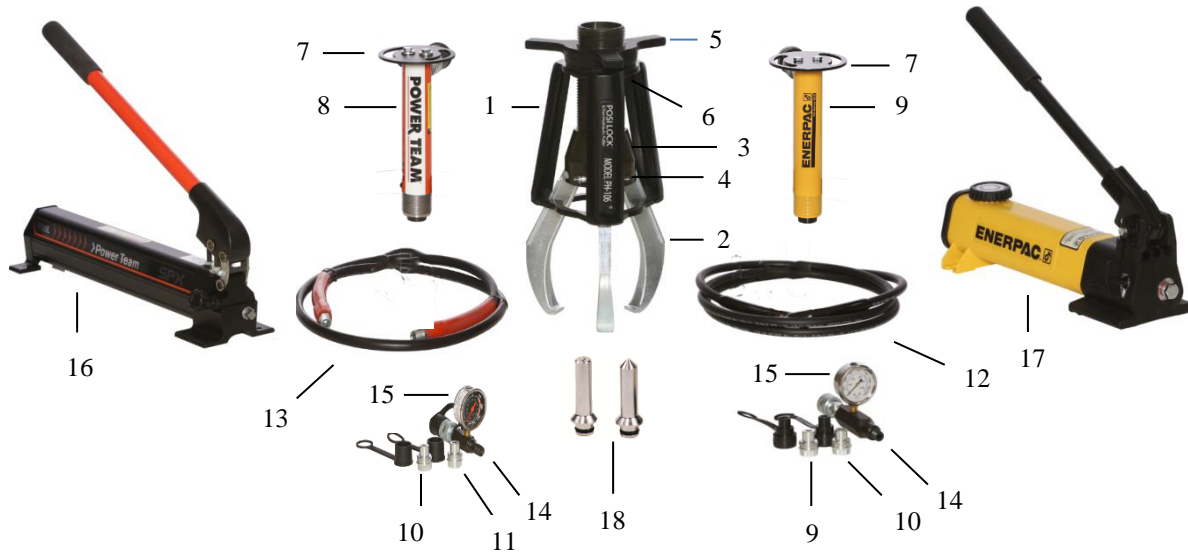

PHMS-106 Consists of:

Description	Part #
1 Cage®- 3 Jaw	PH-10653
2 Jaw	10654
3 Jaw Head Assembly	PH-10655
4 Pin	11056
5 T-Handle	PH-10657
6 Snap Ring	11659
7 Lift Plate	PH-10652
8 Power Team Cylinder	C55C
9 Enerpac Cylinder	RC-55
10 Female Coupler	CR-400
11 Male Coupler	CH-604
12 10 ft. Heavy Duty Hose Posi Lock	PH-927
13 10 ft. Power Team Hose	9758
14 Gauge Adapter	GA-3
15 Gauge (10,000 psi)	G2535L
16 2 Stage Hand Pump Power Team	P19L
17 2 Stage Hand Pump Enerpac	P-142
18 Set of 6 Interchangeable Ram Points	PH-5-3
Set Includes:	
1-Flat Ram Point .63 x 2.3 (16 x 59mm)	PH-5-1
1-Tapered Ram Point .63 x 2.4 (16 x 61mm)	PH-5-2



PHMS-108 Consists of:

Description	Part #
1 Cage@- 3 Jaw	PH-10853
2 Jaw	10854
3 Jaw Head Assembly	PH-10855
4 Pin	PH-10856
5 T-Handle	PH-10857
6 Snap Ring	PH-10859
7 Lift Plate	PH-11052
8 Power Team Cylinder	C106C
9 Enerpac Cylinder	RC-106
10 Female Coupler	CR-400
11 Male Coupler	CH-604
12 10 ft. Heavy Duty Hose Posi Lock	PH-927
13 10 ft. Power Team Hose	9758
14 Gauge Adapter	GA-3
15 Gauge (10,000 psi)	G2535L
16 2 Stage Hand Pump Power Team	P19L
17 2 Stage Hand Pump Enerpac	P-142
18 Set of 6 Interchangeable Ram Points	PH-15-5
Set Includes:	
1-Flat Ram Point 1 x 1 (25 x 25mm)	PH-15-1
1-Flat Ram Point 1 x 3 (25 x 76mm)	PH-15-2
1-Tapered Ram Point 1 x 1.5 (25 x 38mm)	PH-15-3
1-Tapered Ram Point 1 x 3.5 (25 x 89mm)	PH-15-4

Алматы (7273)495-231
Архангельск (8182)63-90-72
Астрахань (8512)99-46-04
Барнаул (3852)73-04-60
Белгород (4722)40-23-64
Брянск (4832)59-03-52
Владивосток (423)249-28-31
Волгоград (844)278-03-48
Вологда (8172)26-41-59
Воронеж (473)204-51-73
Екатеринбург (343)384-55-89
Иваново (4932)77-34-06

Ижевск (3412)26-03-58
Иркутск (395)279-98-46
Казань (843)206-01-48
Калининград (4012)72-03-81
Калуга (4842)92-23-67
Кемерово (3842)65-04-62
Киров (8332)68-02-04
Краснодар (861)203-40-90
Красноярск (391)204-63-61
Курск (4712)77-13-04
Липецк (4742)52-20-81

Магнитогорск (3519)55-03-13
Москва (495)268-04-70
Мурманск (8152)59-64-93
Набережные Челны (8552)20-53-41
Нижегород (831)429-08-12
Новокузнецк (3843)20-46-81
Новосибирск (383)227-86-73
Омск (3812)21-46-40
Орел (4862)44-53-42
Оренбург (3532)37-68-04
Пенза (8412)22-31-16

Пермь (342)205-81-47
Ростов-на-Дону (863)308-18-15
Рязань (4912)46-61-64
Самара (846)206-03-16
Санкт-Петербург (812)309-46-40
Саратов (845)249-38-78
Севастополь (8692)22-31-93
Симферополь (3652)67-13-56
Смоленск (4812)29-41-54
Сочи (862)225-72-31
Ставрополь (8652)20-65-13

Сургут (3462)77-98-35
Тверь (4822)63-31-35
Томск (3822)98-41-53
Тула (4872)74-02-29
Тюмень (3452)66-21-18
Ульяновск (8422)24-23-59
Уфа (347)229-48-12
Хабаровск (4212)92-98-04
Челябинск (351)202-03-61
Череповец (8202)49-02-64
Ярославль (4852)69-52-93



PHMS-110 Consists of:

Description	Part #
1 Cage®- 3 Jaw	PH-11053
2 Jaw	PH-11054
3 Jaw Head Assembly	PH-11055
4 Pin	PH-11056
5 T-Handle	PH-11057
6 Snap Ring	PH-11059
7 Lift Plate	PH-11052
8 Power Team Cylinder	C1510C
9 Enerpac Cylinder	RC-1510
10 Female Coupler	CR-400
11 Male Coupler	CH-604
12 10 ft. Heavy Duty Hose Posi Lock	PH-927
13 10 ft. Power Team Hose	9758
14 Gauge Adapter	GA-3
15 Gauge (10,000 psi)	G2535L
16 2 Stage Hand Pump Power Team	P59L
17 2 Stage Hand Pump Enerpac	P-80
18 Set of 6 Interchangeable Ram Points	PH-15-5
Set Includes:	
1-Flat Ram Point 1 x 1 (25 x 25mm)	PH-15-1
1-Flat Ram Point 1 x 3 (25 x 76mm)	PH-15-2
1-Tapered Ram Point 1 x 1.5 (25 x 38mm)	PH-15-3
1-Tapered Ram Point 1 x 3.5 (25 x 89mm)	PH-15-4



PHMS-113 Consists of:

Description	Part #
1 Cage®- 3 Jaw	PH-11353
2 Jaw	11354
3 Jaw Head Assembly	PH-11355
4 Pin	11356
5 T-Handle	PH-11357
6 Snap Ring	PH-11359
7 Lift Plate	PH-11352
8 Power Team Cylinder	C2514C
9 Enerpac Cylinder	RC-2514
10 Female Coupler	CR-400
11 Male Coupler	CH-604
12 10 ft. Heavy Duty Hose Posi Lock	PH-927
13 10 ft. Power Team Hose	9758
14 Gauge Adapter	GA-3
15 Gauge (10,000 psi)	G2535L
16 2 Stage Hand Pump Power Team	P159
17 2 Stage Hand Pump Enerpac	P-80
18 Set of 6 Interchangeable Ram Points	PH-25-7
Set Includes:	
1-Flat Ram Point 1.5 x 2.25 (38 x 57mm)	PH-25-1
1-Flat Ram Point 2 x 2.25 (51 x 64mm)	PH-25-2
1-Flat Ram Point 2 x 4 (51 x 102mm)	PH-25-3
1-Tapered Ram Point 1.5 x 2.5 (38 x 64mm)	PH-25-4
1-Tapered Ram Point 2 x 2.5 (51 x 64mm)	PH-25-5
1-Tapered Ram Point 2 x 4.5 (51 x 114mm)	PH-25-6
19 Storage Transport Cart	PT-2550



PHMS-116 Consists of:

Description	Part #
1 Cage®- 3 Jaw	PH-11653
2 Jaw	PH-11654
3 Jaw Head Assembly	PH-11655
4 Pin	PH-11656
5 T-Handle	PH-11657
6 Snap Ring	PH-11659
7 Lift Plate	PH-11652
8 Power Team Cylinder	C5513C
9 Enerpac Cylinder	RC-5013
10 Female Coupler	CR-400
11 Male Coupler	CH-604
12 10 ft. Heavy Duty Hose Posi Lock	PH-927
13 10 ft. Power Team Hose	9758
14 Gauge Adapter	GA-3
15 Gauge (10,000 psi)	G2535L
16 2 Stage Hand Pump Power Team	P460
17 2 Stage Hand Pump Enerpac	P-462
18 Set of 6 Interchangeable Ram Points	PH-50-8
Set Includes:	
1-Flat Ram Point 2 x 3 (51 x 76 mm)	PH-50-1
1-Flat Ram Point 2.75 x 3 (70 x 76mm)	PH-50-2
1-Flat Ram Point 2.75 x 5 (70 x 127mm)	PH-50-3
1-Tapered Ram Point 2 x 3.75 (51 x 95 mm)	PH-50-4
1-Tapered Ram Point 2.75 x 3.75 (70 x 95mm)	PH-50-5
1-Tapered Ram Point 2.75 x 5.5 (70 x 140mm)	PH-50-6
1-Ram Point Adapter 2.75 x 2.25 (70 x 57mm)	PH-50-7
19 Storage Transport Cart	PT-2550

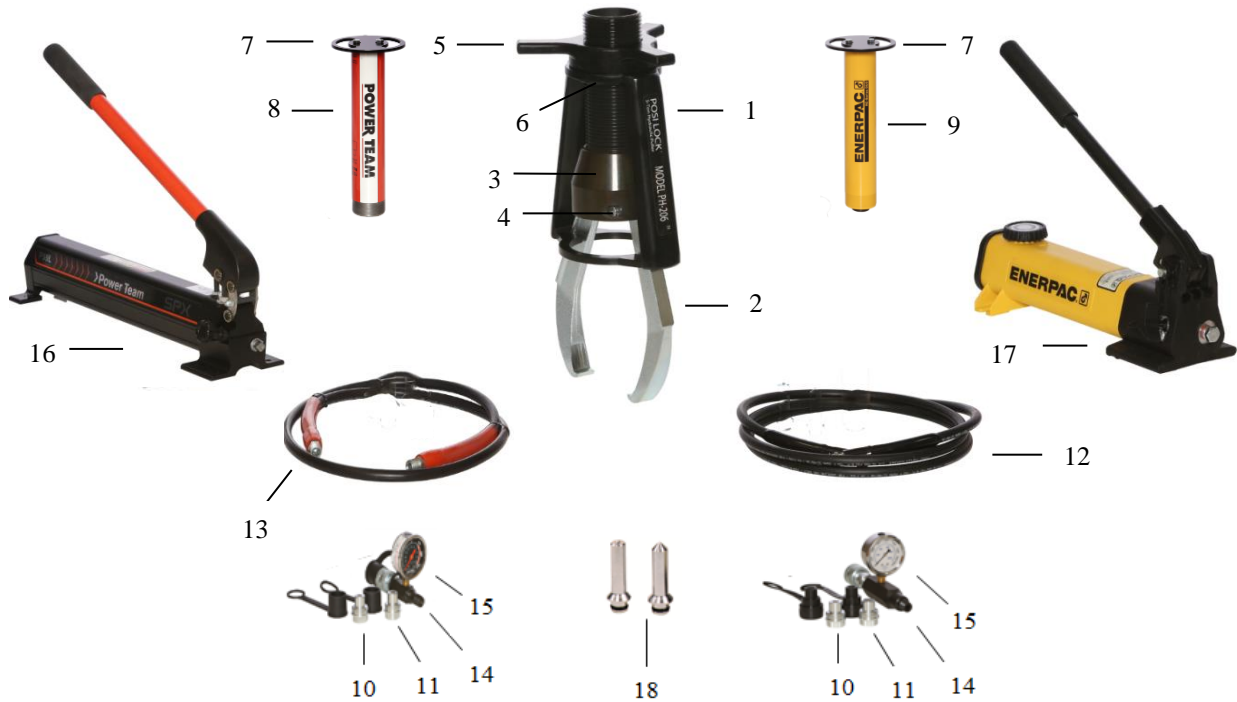

PHMS-206 Consists of:

Description	Part #
1 Cage®- 2 Jaw	PH-20653
2 Jaw	10654
3 Jaw Head Assembly	PH-20655
4 Pin	11056
5 T-Handle	PH-10657
6 Snap Ring	11659
7 Lift Plate	PH-10652
8 Power Team Cylinder	C55C
9 Enerpac Cylinder	RC-55
10 Female Coupler	CR-400
11 Male Coupler	CH-604
12 10 ft. Heavy Duty Hose	PH-927
13 10 ft. Power Team Hose	9785
14 Gauge Adapter	GA-3
15 Gauge (10,000 psi)	G2535L
16 2 Stage Hand Pump Power Team	P19L
17 2 Stage Hand Pump Enerpac	P-142
18 Set of 6 Interchangeable Ram Points	PH-5-3
Set Includes:	
1-Flat Ram Point .63 x 2.3 (16 x 59mm)	PH-5-1
1-Tapered Ram Point .63 x 2.4 (16 x 61mm)	PH-5-2

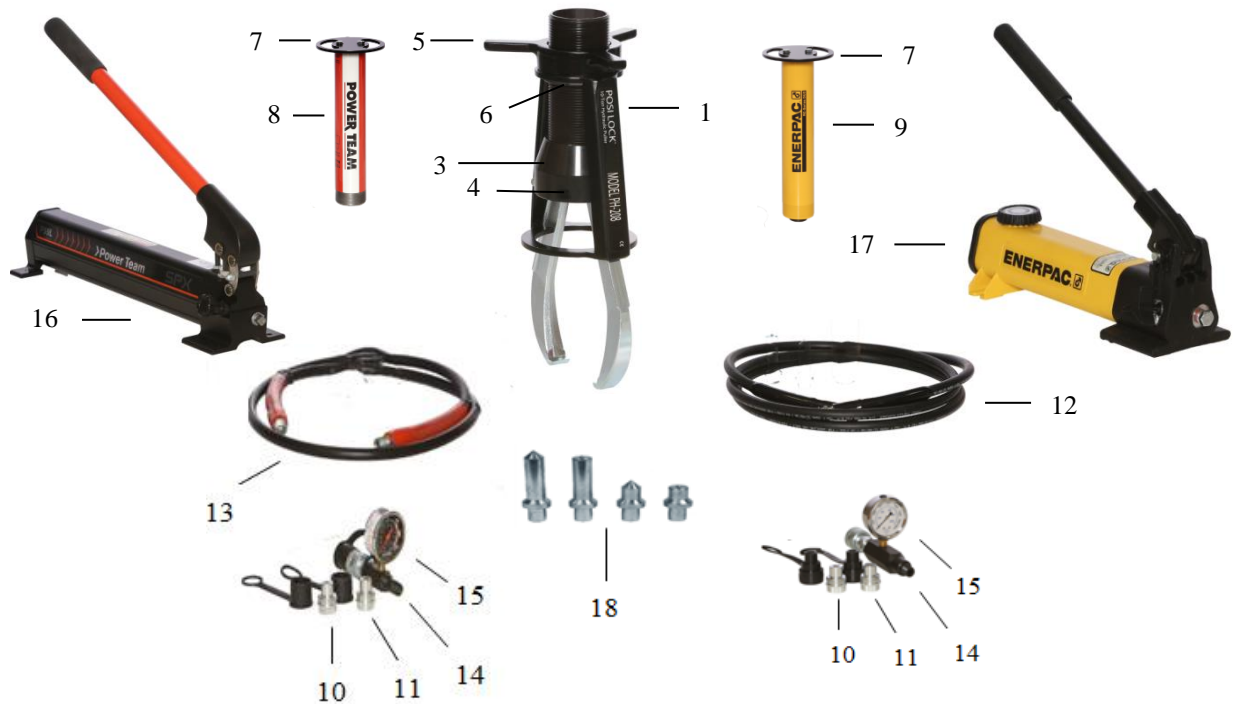

PHMS-208 Consists of:

Description	Part #
1 Cage®- 2 Jaw	PH-20853
2 Jaw	10854
3 Jaw Head Assembly	PH-20855
4 Pin	PH-10856
5 T-Handle	PH-10857
6 Snap Ring	PH-10859
7 Lift Plate	PH-11052
8 Power Team Cylinder	C106C
9 Enerpac Cylinder	RC-106
10 Female Coupler	CR-400
11 Male Coupler	CH-604
12 10 ft. Heavy Duty Hose	PH-927
13 10 ft. Power Team Hose	9785
14 Gauge Adapter	GA-3
15 Gauge (10,000 psi)	G2535L
16 2 Stage Hand Pump Power Team	P19L
17 2 Stage Hand Pump Enerpac	P-142
18 Set of 6 Interchangeable Ram Points	PH-15-5
Set Includes:	
1-Flat Ram Point 1 x 1 (25 x 25mm)	PH-15-1
1-Flat Ram Point 1 x 3 (25 x 76mm)	PH-15-2
1-Tapered Ram Point 1 x 1.5 (25 x 38mm)	PH-15-3
1-Tapered Ram Point 1 x 3.5 (25 x 89mm)	PH-15-4

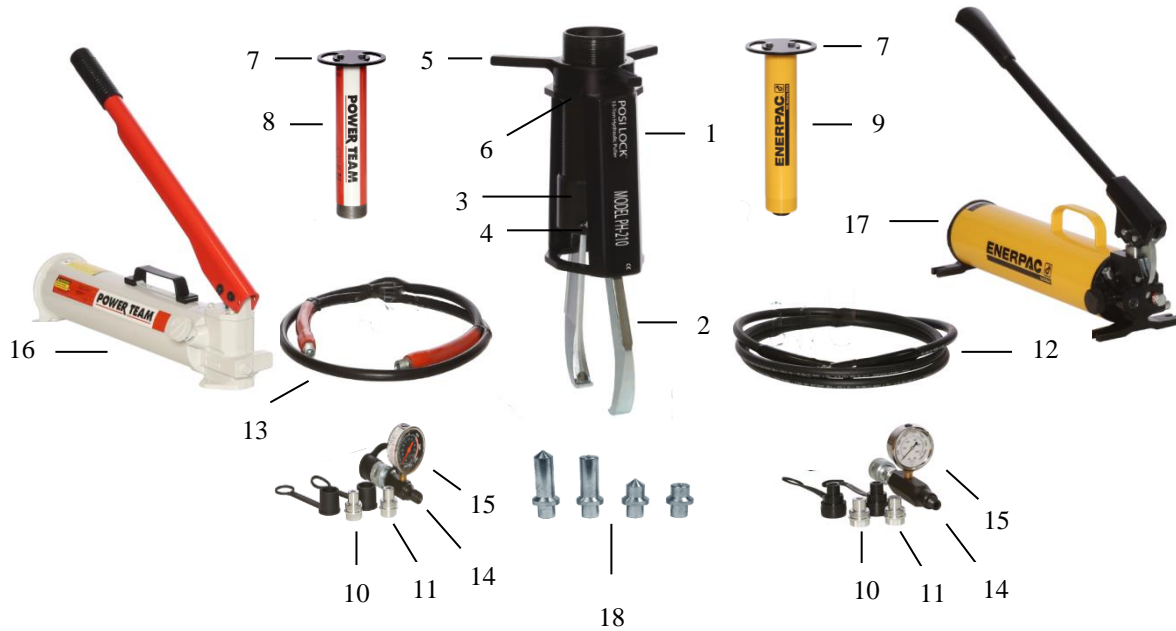

PHMS-210 Consists of:

Description	Part #
1 Cage®- 2 Jaw	PH-21053
2 Jaw	PH-11054
3 Jaw Head Assembly	PH-21055
4 Pin	PH-11056
5 T-Handle	PH-11057
6 Snap Ring	PH-11059
7 Lift Plate	PH-11052
8 Power Team Cylinder	C1510C
9 Enerpac Cylinder	RC-1510
10 Female Coupler	CR-400
11 Male Coupler	CH-604
12 10 ft. Heavy Duty Hose Posi Lock	PH-927
13 10 ft. Power Team Hose	9785
14 Gauge Adapter	GA-3
15 Gauge (10,000 psi)	G2535L
16 2 Stage Hand Pump Power Team	P59L
17 2 Stage Hand Pump Enerpac	P-80
18 Set of 6 Interchangeable Ram Points	PH-15-5
Set Includes:	
1-Flat Ram Point 1 x 1 (25 x 25mm)	PH-15-1
1-Flat Ram Point 1 x 3 (25 x 76mm)	PH-15-2
1-Tapered Ram Point 1 x 1.5 (25 x 38mm)	PH-15-3
1-Tapered Ram Point 1 x 3.5 (25 x 89mm)	PH-15-4



PHMS-213 Consists of:

Description	Part #
1 Cage®- 2 Jaw	PH-21353
2 Jaw	11354
3 Jaw Head Assembly	PH-21355
4 Pin	11356
5 T-Handle	PH-11357
6 Snap Ring	PH-11359
7 Lift Plate	PH-11352
8 Power Team Cylinder	C2514C
9 Enerpac Cylinder	RC-2514
10 Female Coupler	CR-400
11 Male Coupler	CH-604
12 10 ft. Heavy Duty Hose	PH-927
13 10 ft. Power Team Hose	9785
14 Gauge Adapter	GA-3
15 Gauge (10,000 psi)	G2535L
16 2 Stage Hand Pump Power Team	P159
17 2 Stage Hand Pump Enerpac	P-80
18 Set of 6 Interchangeable Ram Points	PH-25-7
Set Includes:	
1-Flat Ram Point 1.5 x 2.25 (38 x 57mm)	PH-25-1
1-Flat Ram Point 2 x 2.25 (51 x 64mm)	PH-25-2
1-Flat Ram Point 2 x 4 (51 x 102mm)	PH-25-3
1-Tapered Ram Point 1.5 x 2.5 (38 x 64mm)	PH-25-4
1-Tapered Ram Point 2 x 2.5 (51 x 64mm)	PH-25-5
1-Tapered Ram Point 2 x 4.5 (51 x 114mm)	PH-25-6
19 Storage Transport Cart	PT-2550

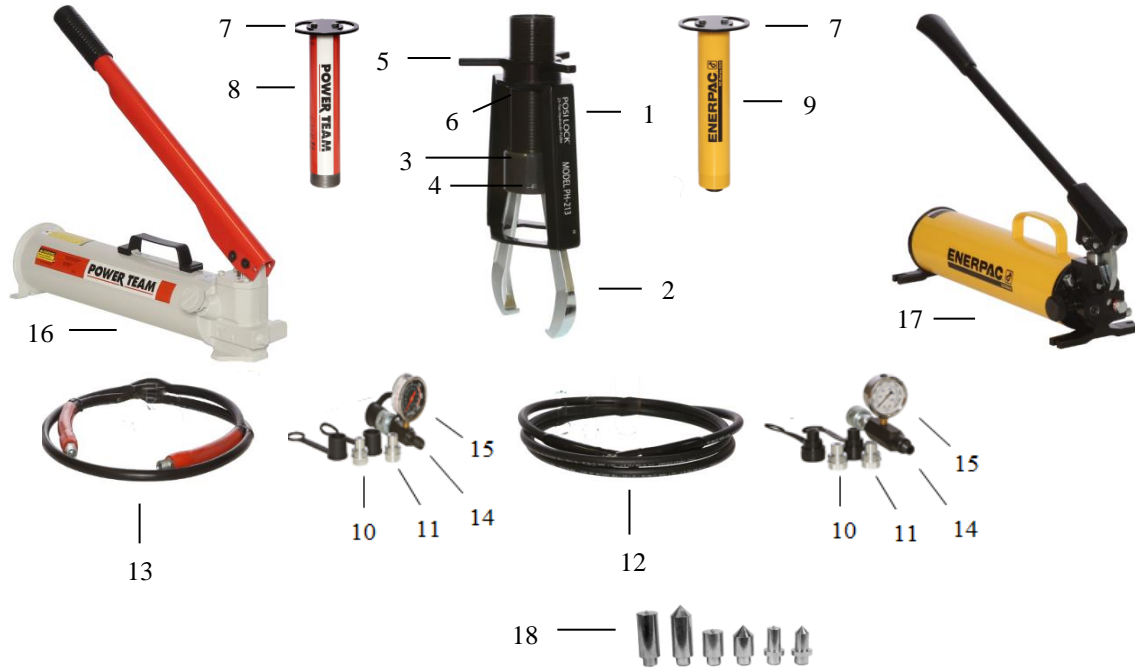

PHES-213 Consists of:

Description	Part #
1 Cage®- 2 Jaw	PH-21353
2 Jaw	11354
3 Jaw Head Assembly	PH-21355
4 Pin	11356
5 T-Handle	PH-11357
6 Snap Ring	PH-11359
7 Lift Plate	PH-11352
8 Power Team Cylinder	C2514C
9 Enerpac Cylinder	RC-2514
10 Female Coupler	CR-400
11 Male Coupler	CH-604
12 10 ft. Heavy Duty Hose	PH-927
13 10 ft. Power Team Hose	9785
14 Gauge Adapter	GA-3
15 Gauge (10,000 psi)	G2535L
16 2 Stage Hand Pump Power Team	P159
17 2 Stage Hand Pump Enerpac	P-80
18 Set of 6 Interchangeable Ram Points	PH-25-7
Set Includes:	
1-Flat Ram Point 1.5 x 2.25 (38 x 57mm)	PH-25-1
1-Flat Ram Point 2 x 2.25 (51 x 64mm)	PH-25-2
1-Flat Ram Point 2 x 4 (51 x 102mm)	PH-25-3
1-Tapered Ram Point 1.5 x 2.5 (38 x 64mm)	PH-25-4
1-Tapered Ram Point 2 x 2.5 (51 x 64mm)	PH-25-5
1-Tapered Ram Point 2 x 4.5 (51 x 114mm)	PH-25-6

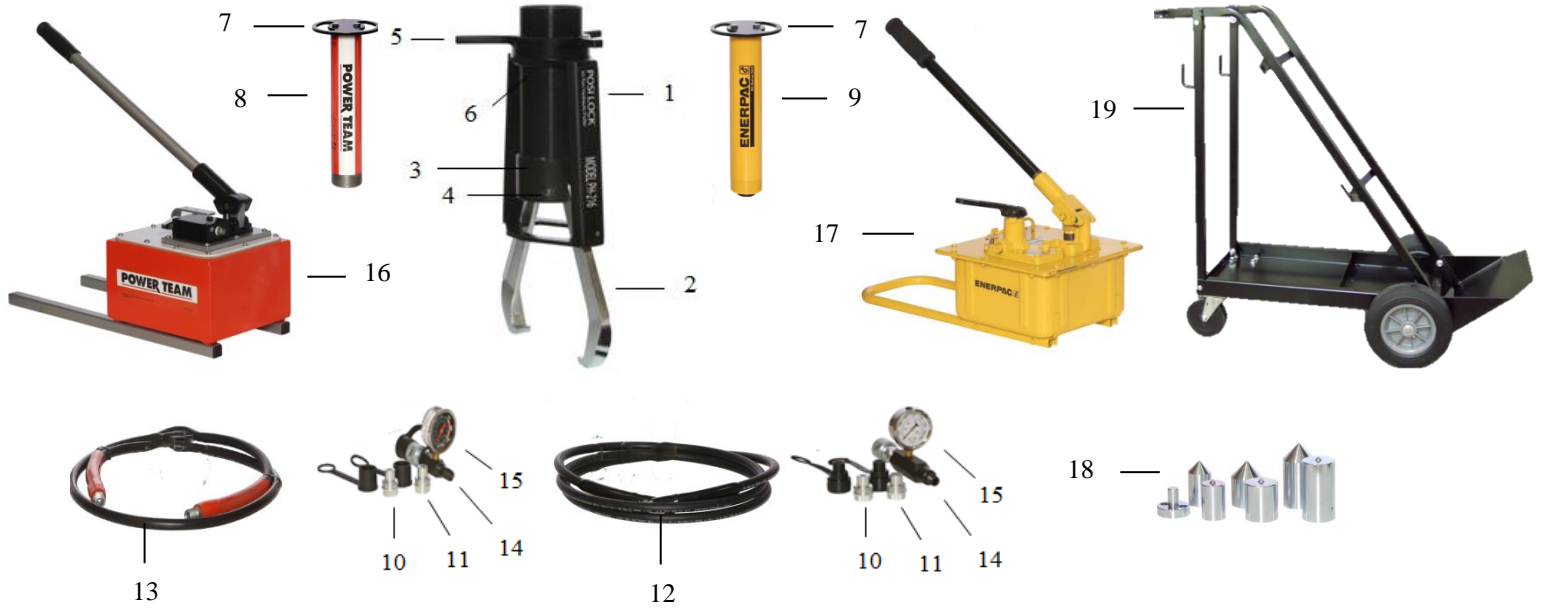

PHMS-216 Consists of:

Description	Part #
1 Cage®- 2 Jaw	PH-21653
2 Jaw	PH-21654
3 Jaw Head Assembly	PH-21655
4 Pin	PH-21656
5 T-Handle	PH-11657
6 Snap Ring	PH-11659
7 Lift Plate	PH-11652
8 Power Team Cylinder	C5513C
9 Enerpac Cylinder	RC-5013
10 Female Coupler	CR-400
11 Male Coupler	CH-604
12 10 ft. Heavy Duty Hose	PH-927
13 10 ft. Power Team Hose	9785
14 Gauge Adapter	GA-3
15 Gauge (10,000 psi)	G2535L
16 2 Stage Hand Pump Power Team	P460
17 2 Stage Hand Pump Enerpac	P-462
18 Set of 6 Interchangeable Ram Points	PH-50-8
Set Includes:	
1-Flat Ram Point 2 x 3 (51 x 76 mm)	PH-50-1
1-Flat Ram Point 2.75 x 3 (70 x 76mm)	PH-50-2
1-Flat Ram Point 2.75 x 5 (70 x 127mm)	PH-50-3
1-Tapered Ram Point 2 x 3.75 (51 x 95mm)	PH-50-4
1-Tapered Ram Point 2.75 x 3.75 (70 x 95mm)	PH-50-5
1-Tapered Ram Point 2.75 x 5.5 (70 x 140mm)	PH-50-6
1-Ram Point Adapter 2.75 x 2.25 (70 x 57mm)	PH-50-7
19 Storage Transport Cart	PT-2550

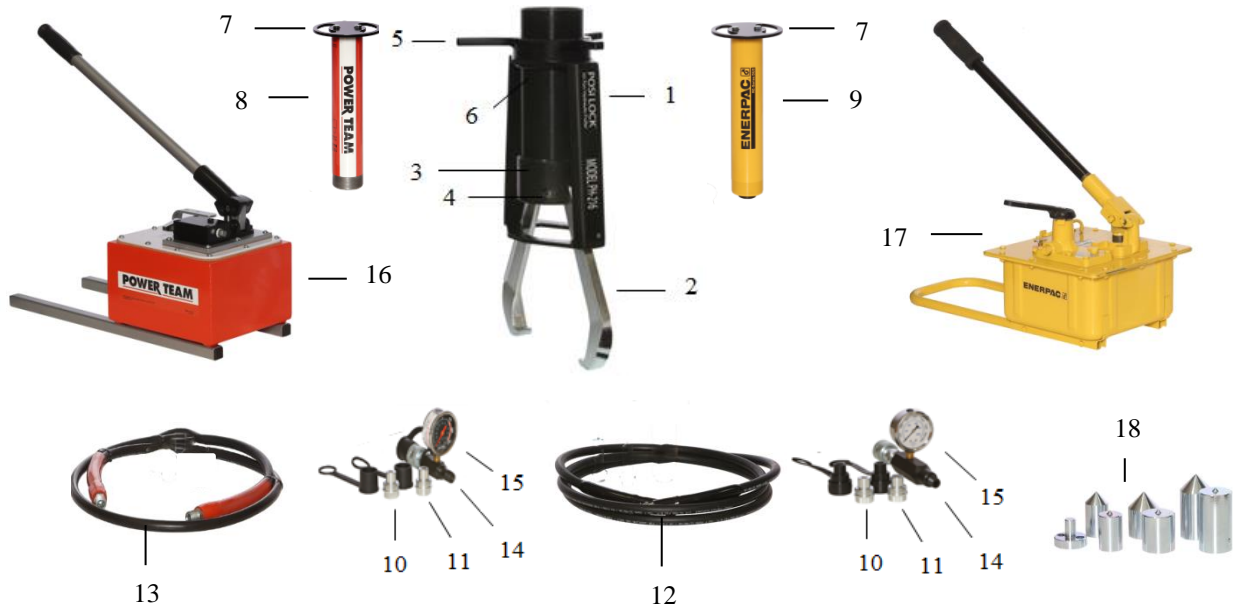

PHMS-216 Consists of:

Description	Part #
1 Cage®- 2 Jaw	PH-21653
2 Jaw	PH-21654
3 Jaw Head Assembly	PH-21655
4 Pin	PH-21656
5 T-Handle	PH-11657
6 Snap Ring	PH-11659
7 Lift Plate	PH-11652
8 Power Team Cylinder	C5513C
9 Enerpac Cylinder	RC-5013
10 Female Coupler	CR-400
11 Male Coupler	CH-604
12 10 ft. Heavy Duty Hose	PH-927
13 10 ft. Power Team Hose	9785
14 Gauge Adapter	GA-3
15 Gauge (10,000 psi)	G2535L
16 2 Stage Hand Pump Power Team	P460
17 2 Stage Hand Pump Enerpac	P-462
18 Set of 6 Interchangeable Ram Points	PH-50-8
Set Includes:	
1-Flat Ram Point 2 x 3 (51 x 76 mm)	PH-50-1
1-Flat Ram Point 2.75 x 3 (70 x 76mm)	PH-50-2
1-Flat Ram Point 2.75 x 5 (70 x 127mm)	PH-50-3
1-Tapered Ram Point 2 x 3.75 (51 x 95mm)	PH-50-4
1-Tapered Ram Point 2.75 x 3.75 (70 x 95mm)	PH-50-5
1-Tapered Ram Point 2.75 x 5.5 (70 x 140mm)	PH-50-6
1-Ram Point Adapter 2.75 x 2.25 (70 x 57mm)	PH-50-7

Алматы (7273)495-231
Архангельск (8182)63-90-72
Астрахань (8512)99-46-04
Барнаул (3852)73-04-60
Белгород (4722)40-23-64
Брянск (4832)59-03-52
Владивосток (423)249-28-31
Волгоград (844)278-03-48
Вологда (8172)26-41-59
Воронеж (473)204-51-73
Екатеринбург (343)384-55-89
Иваново (4932)77-34-06

Ижевск (3412)26-03-58
Иркутск (395)279-98-46
Казань (843)206-01-48
Калининград (4012)72-03-81
Калуга (4842)92-23-67
Кемерово (3842)65-04-62
Киров (8332)68-02-04
Краснодар (861)203-40-90
Красноярск (391)204-63-61
Курск (4712)77-13-04
Липецк (4742)52-20-81

Магнитогорск (3519)55-03-13
Москва (495)268-04-70
Мурманск (8152)59-64-93
Набережные Челны (8552)20-53-41
Нижний Новгород (831)429-08-12
Новокузнецк (3843)20-46-81
Новосибирск (383)227-86-73
Омск (3812)21-46-40
Орел (4862)44-53-42
Оренбург (3532)37-68-04
Пенза (8412)22-31-16

Пермь (342)205-81-47
Ростов-на-Дону (863)308-18-15
Рязань (4912)46-61-64
Самара (846)206-03-16
Санкт-Петербург (812)309-46-40
Саратов (845)249-38-78
Севастополь (8692)22-31-93
Симферополь (3652)67-13-56
Смоленск (4812)29-41-54
Сочи (862)225-72-31
Ставрополь (8652)20-65-13

Сургут (3462)77-98-35
Тверь (4822)63-31-35
Томск (3822)98-41-53
Тула (4872)74-02-29
Тюмень (3452)66-21-18
Ульяновск (8422)24-23-59
Уфа (347)229-48-12
Хабаровск (4212)92-98-04
Челябинск (351)202-03-61
Череповец (8202)49-02-64
Ярославль (4852)69-52-93

Киргизия (996)312-96-26-47

Россия (495)268-04-70

Казахстан (7172)727-132