

Алматы (7273)495-231
Архангельск (8182)63-90-72
Астрахань (8512)99-46-04
Барнаул (3852)73-04-60
Белгород (4722)40-23-64
Брянск (4832)59-03-52
Владивосток (423)249-28-31
Волгоград (844)278-03-48
Вологда (8172)26-41-59
Воронеж (473)204-51-73
Екатеринбург (343)384-55-89
Иваново (4932)77-34-06

Ижевск (3412)26-03-58
Иркутск (395)279-98-46
Казань (843)206-01-48
Калининград (4012)72-03-81
Калуга (4842)92-23-67
Кемерово (3842)65-04-62
Киров (8332)68-02-04
Краснодар (861)203-40-90
Красноярск (391)204-63-61
Курск (4712)77-13-04
Липецк (4742)52-20-81

Магнитогорск (3519)55-03-13
Москва (495)268-04-70
Мурманск (8152)59-64-93
Набережные Челны (8552)20-53-41
Нижний Новгород (831)429-08-12
Новокузнецк (3843)20-46-81
Новосибирск (383)227-86-73
Омск (3812)21-46-40
Орел (4862)44-53-42
Оренбург (3532)37-68-04
Пенза (8412)22-31-16

Пермь (342)205-81-47
Ростов-на-Дону (863)308-18-15
Рязань (4912)46-61-64
Самара (846)206-03-16
Санкт-Петербург (812)309-46-40
Саратов (845)249-38-78
Севастополь (8692)22-31-93
Симферополь (3652)67-13-56
Смоленск (4812)29-41-54
Сочи (862)225-72-31
Ставрополь (8652)20-65-13

Сургут (3462)77-98-35
Тверь (4822)63-31-35
Томск (3822)98-41-53
Тула (4872)74-02-29
Тюмень (3452)66-21-18
Ульяновск (8422)24-23-59
Уфа (347)229-48-12
Хабаровск (4212)92-98-04
Челябинск (351)202-03-61
Череповец (8202)49-02-64
Ярославль (4852)69-52-93

Киргизия (996)312-96-26-47

Россия (495)268-04-70

Казахстан (7172)727-132

<https://posilock.nt-rt.ru/> | pfk@nt-rt.ru

Details

PHSE

106/108/110/113/113NC/116/
116NC/208/206/210/213/216

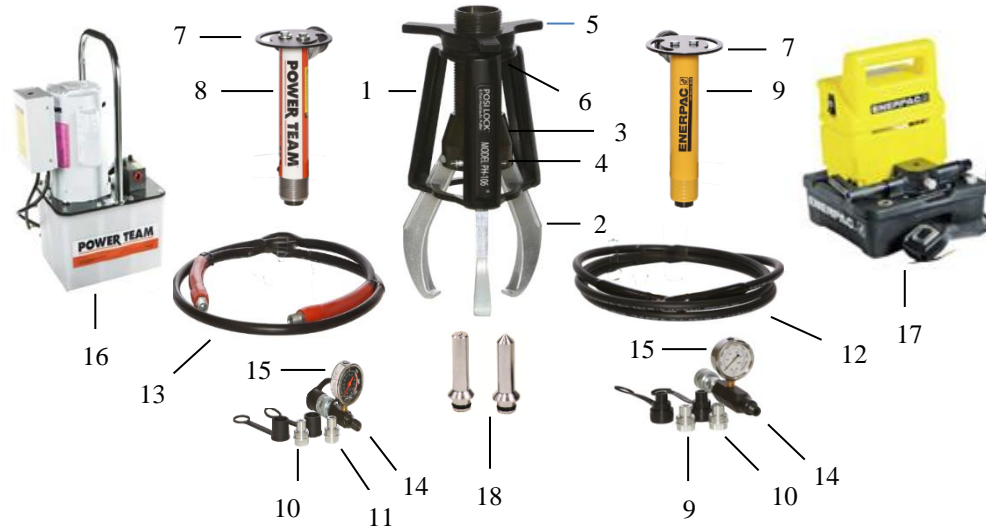

PHES-106 Consists of:

| Description | Part # |
|---|-----------|
| 1 Cage®- 3 Jaw | PH-10653 |
| 2 Jaw | 10654 |
| 3 Jaw Head Assembly | PH-10655 |
| 4 Pin | 11056 |
| 5 T-Handle | PH-10657 |
| 6 Snap Ring | 11659 |
| 7 Lift Plate | PH-10652 |
| 8 Power Team Cylinder | C55C |
| 9 Enerpac Cylinder | RC-55 |
| 10 Female Coupler | CR-400 |
| 11 Male Coupler | CH-604 |
| 12 10 ft. Heavy Duty Hose Posi Lock | PH-927 |
| 13 10 ft. Power Team Hose | 9758 |
| 14 Gauge Adapter | GA-3 |
| 15 Gauge (10,000 psi) | G2535L |
| 16 2 Stage Electric Pump Power Team | PE172 |
| 17 2 Stage Electric Pump Enerpac | PUJ-1200B |
| 18 Set of 6 Interchangeable Ram Points | PH-5-3 |
| Set Includes: | |
| 1-Flat Ram Point .63 x 2.3 (16 x 59mm) | PH-5-1 |
| 1-Tapered Ram Point .63 x 2.4 (16 x 61mm) | PH-5-2 |



PHES-108 Consists of:

| Description | Part # |
|---|-----------|
| 1 Cage@- 3 Jaw | PH-10853 |
| 2 Jaw | 10854 |
| 3 Jaw Head Assembly | PH-10855 |
| 4 Pin | PH-10856 |
| 5 T-Handle | PH-10857 |
| 6 Snap Ring | PH-10859 |
| 7 Lift Plate | PH-11052 |
| 8 Power Team Cylinder | C106C |
| 9 Enerpac Cylinder | RC-106 |
| 10 Female Coupler | CR-400 |
| 11 Male Coupler | CH-604 |
| 12 10 ft. Heavy Duty Hose Posi Lock | PH-927 |
| 13 10 ft. Power Team Hose | 9758 |
| 14 Gauge Adapter | GA-3 |
| 15 Gauge (10,000 psi) | G2535L |
| 16 2 Stage Electric Pump Power Team | PE172 |
| 17 2 Stage Electric Pump Enerpac | PUJ-1200B |
| 18 Set of 6 Interchangeable Ram Points | PH-15-5 |
| Set Includes: | |
| 1-Flat Ram Point 1 x 1 (25 x 25mm) | PH-15-1 |
| 1-Flat Ram Point 1 x 3 (25 x 76mm) | PH-15-2 |
| 1-Tapered Ram Point 1 x 1.5 (25 x 38mm) | PH-15-3 |
| 1-Tapered Ram Point 1 x 3.5 (25 x 89mm) | PH-15-4 |



.110 Consists of:

| Description | Part # |
|---|-----------|
| 1 Cage®- 3 Jaw | PH-11053 |
| 2 Jaw | PH-11054 |
| 3 Jaw Head Assembly | PH-11055 |
| 4 Pin | PH-11056 |
| 5 T-Handle | PH-11057 |
| 6 Snap Ring | PH-11059 |
| 7 Lift Plate | PH-11052 |
| 8 Power Team Cylinder | C1510C |
| 9 Enerpac Cylinder | RC-1510 |
| 10 Female Coupler | CR-400 |
| 11 Male Coupler | CH-604 |
| 12 10 ft. Heavy Duty Hose Posi Lock | PH-927 |
| 13 10 ft. Power Team Hose | 9758 |
| 14 Gauge Adapter | GA-3 |
| 15 Gauge (10,000 psi) | G2535L |
| 16 2 Stage Electric Pump Power Team | PE172 |
| 17 2 Stage Electric Pump Enerpac | PUJ-1200B |
| 18 Set of 6 Interchangeable Ram Points | PH-15-5 |
| Set Includes: | |
| 1-Flat Ram Point 1 x 1 (25 x 25mm) | PH-15-1 |
| 1-Flat Ram Point 1 x 3 (25 x 76mm) | PH-15-2 |
| 1-Tapered Ram Point 1 x 1.5 (25 x 38mm) | PH-15-3 |
| 1-Tapered Ram Point 1 x 3.5 (25 x 89mm) | PH-15-4 |



PHES-113 Consists of:

| Description | Part # |
|---|-----------|
| 1 Cage®- 3 Jaw | PH-11353 |
| 2 Jaw | 11354 |
| 3 Jaw Head Assembly | PH-11355 |
| 4 Pin | 11356 |
| 5 T-Handle | PH-11357 |
| 6 Snap Ring | PH-11359 |
| 7 Lift Plate | PH-11352 |
| 8 Power Team Cylinder | C2514C |
| 9 Enerpac Cylinder | RC-2514 |
| 10 Female Coupler | CR-400 |
| 11 Male Coupler | CH-604 |
| 12 10 ft. Heavy Duty Hose Posi Lock | PH-927 |
| 13 10 ft. Power Team Hose | 9758 |
| 14 Gauge Adapter | GA-3 |
| 15 Gauge (10,000 psi) | G2535L |
| 16 2 Stage Electric Pump Power Team | PE172 |
| 17 2 Stage Electric Pump Enerpac | PUJ-1200B |
| 18 Set of 6 Interchangeable Ram Points | PH-25-7 |
| Set Includes: | |
| 1-Flat Ram Point 1.5 x 2.25 (38 x 57mm) | PH-25-1 |
| 1-Flat Ram Point 2 x 2.25 (51 x 64mm) | PH-25-2 |
| 1-Flat Ram Point 2 x 4 (51 x 102mm) | PH-25-3 |
| 1-Tapered Ram Point 1.5 x 2.5 (38 x 64mm) | PH-25-4 |
| 1-Tapered Ram Point 2 x 2.5 (51 x 64mm) | PH-25-5 |
| 1-Tapered Ram Point 2 x 4.5 (51 x 114mm) | PH-25-6 |
| 19 Storage Transport Cart | PT-2550 |



PHES-113 Consists of:

| Description | Part # |
|---|-----------|
| 1 Cage®- 3 Jaw | PH-11353 |
| 2 Jaw | 11354 |
| 3 Jaw Head Assembly | PH-11355 |
| 4 Pin | 11356 |
| 5 T-Handle | PH-11357 |
| 6 Snap Ring | PH-11359 |
| 7 Lift Plate | PH-11352 |
| 8 Power Team Cylinder | C2514C |
| 9 Enerpac Cylinder | RC-2514 |
| 10 Female Coupler | CR-400 |
| 11 Male Coupler | CH-604 |
| 12 10 ft. Heavy Duty Hose Posi Lock | PH-927 |
| 13 10 ft. Power Team Hose | 9758 |
| 14 Gauge Adapter | GA-3 |
| 15 Gauge (10,000 psi) | G2535L |
| 16 2 Stage Electric Pump Power Team | PE172 |
| 17 2 Stage Electric Pump Enerpac | PUJ-1200B |
| 18 Set of 6 Interchangeable Ram Points | PH-25-7 |
| Set Includes: | |
| 1-Flat Ram Point 1.5 x 2.25 (38 x 57mm) | PH-25-1 |
| 1-Flat Ram Point 2 x 2.25 (51 x 64mm) | PH-25-2 |
| 1-Flat Ram Point 2 x 4 (51 x 102mm) | PH-25-3 |
| 1-Tapered Ram Point 1.5 x 2.5 (38 x 64mm) | PH-25-4 |
| 1-Tapered Ram Point 2 x 2.5 (51 x 64mm) | PH-25-5 |
| 1-Tapered Ram Point 2 x 4.5 (51 x 114mm) | PH-25-6 |



PHES-116 Consists of:

| Description | Part # |
|---|----------|
| 1 Cage®- 3 Jaw | PH-11653 |
| 2 Jaw | PH-11654 |
| 3 Jaw Head Assembly | PH-11655 |
| 4 Pin | PH-11656 |
| 5 T-Handle | PH-11657 |
| 6 Snap Ring | PH-11659 |
| 7 Lift Plate | PH-11652 |
| 8 Power Team Cylinder | C5513C |
| 9 Enerpac Cylinder | RC-5013 |
| 10 Female Coupler | CR-400 |
| 11 Male Coupler | CH-604 |
| 12 10 ft. Heavy Duty Hose Posi Lock | PH-927 |
| 13 10 ft. Power Team Hose | 9758 |
| 14 Gauge Adapter | GA-3 |
| 15 Gauge (10,000 psi) | G2535L |
| 16 2 Stage Electric Pump Power Team | PE172 |
| 17 2 Stage Electric Pump Enerpac | ZE3 |
| 18 Set of 6 Interchangeable Ram Points | PH-50-8 |
| Set Includes: | |
| 1-Flat Ram Point 2 x 3 (51 x 76 mm) | PH-50-1 |
| 1-Flat Ram Point 2.75 x 3 (70 x 76mm) | PH-50-2 |
| 1-Flat Ram Point 2.75 x 5 (70 x 127mm) | PH-50-3 |
| 1-Tapered Ram Point 2 x 3.75 (51 x 95 mm) | PH-50-4 |
| 1-Tapered Ram Point 2.75 x 3.75 (70 x 95mm) | PH-50-5 |
| 1-Tapered Ram Point 2.75 x 5.5 (70 x 140mm) | PH-50-6 |
| 1-Ram Point Adapter 2.75 x 2.25 (70 x 57mm) | PH-50-7 |
| 19 Storage Transport Cart | PT-2550 |



PHES-116 Consists of:

| Description | Part # |
|---|----------|
| 1 Cage®- 3 Jaw | PH-11653 |
| 2 Jaw | PH-11654 |
| 3 Jaw Head Assembly | PH-11655 |
| 4 Pin | PH-11656 |
| 5 T-Handle | PH-11657 |
| 6 Snap Ring | PH-11659 |
| 7 Lift Plate | PH-11652 |
| 8 Power Team Cylinder | C5513C |
| 9 Enerpac Cylinder | RC-5013 |
| 10 Female Coupler | CR-400 |
| 11 Male Coupler | CH-604 |
| 12 10 ft. Heavy Duty Hose Posi Lock | PH-927 |
| 13 10 ft. Power Team Hose | 9758 |
| 14 Gauge Adapter | GA-3 |
| 15 Gauge (10,000 psi) | G2535L |
| 16 2 Stage Electric Pump Power Team | PE172 |
| 17 2 Stage Electric Pump Enerpac | ZE3 |
| 18 Set of 6 Interchangeable Ram Points | PH-50-8 |
| Set Includes: | |
| 1-Flat Ram Point 2 x 3 (51 x 76 mm) | PH-50-1 |
| 1-Flat Ram Point 2.75 x 3 (70 x 76mm) | PH-50-2 |
| 1-Flat Ram Point 2.75 x 5 (70 x 127mm) | PH-50-3 |
| 1-Tapered Ram Point 2 x 3.75 (51 x 95 mm) | PH-50-4 |
| 1-Tapered Ram Point 2.75 x 3.75 (70 x 95mm) | PH-50-5 |
| 1-Tapered Ram Point 2.75 x 5.5 (70 x 140mm) | PH-50-6 |
| 1-Ram Point Adapter 2.75 x 2.25 (70 x 57mm) | PH-50-7 |

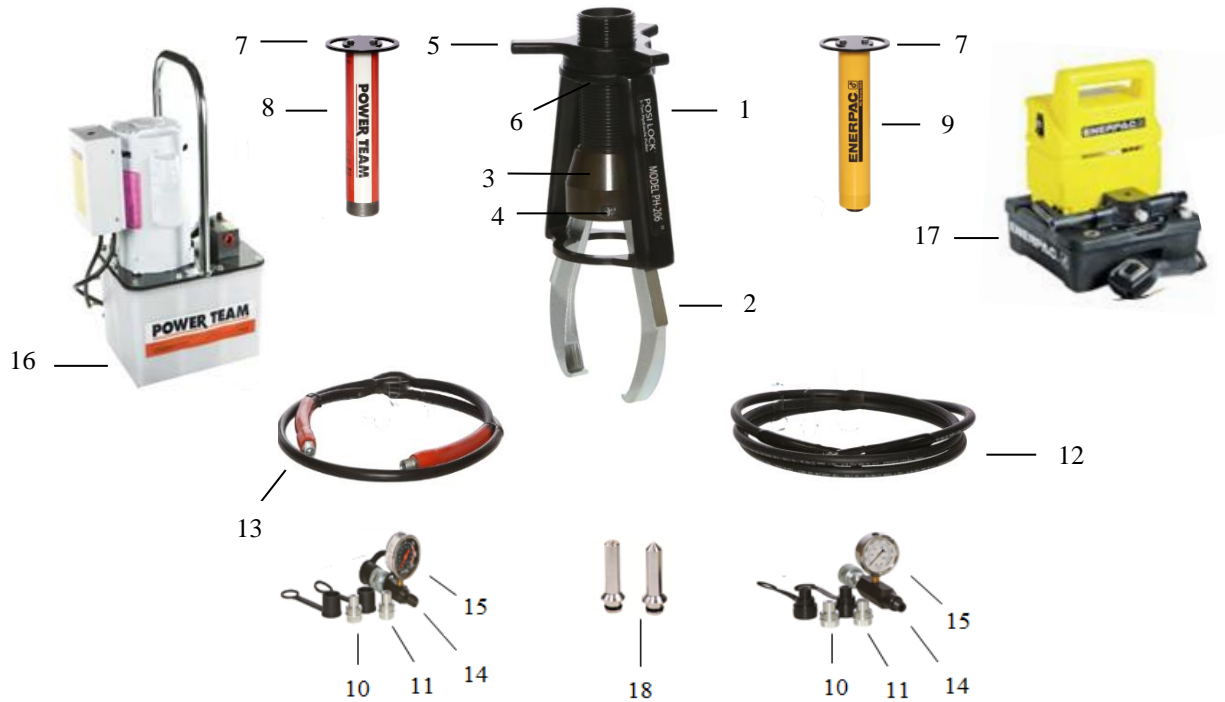

PHES-206 Consists of:

| Description | Part # |
|---|-----------|
| 1 Cage®- 2 Jaw | PH-20653 |
| 2 Jaw | 10654 |
| 3 Jaw Head Assembly | PH-20655 |
| 4 Pin | 11056 |
| 5 T-Handle | PH-10657 |
| 6 Snap Ring | 11659 |
| 7 Lift Plate | PH-10652 |
| 8 Power Team Cylinder | C55C |
| 9 Enerpac Cylinder | RC-55 |
| 10 Female Coupler | CR-400 |
| 11 Male Coupler | CH-604 |
| 12 10 ft. Heavy Duty Hose | PH-927 |
| 13 10 ft. Power Team Hose | 9785 |
| 14 Gauge Adapter | GA-3 |
| 15 Gauge (10,000 psi) | G2535L |
| 16 2 Stage Electric Pump Power Team | PE172 |
| 17 2 Stage Electric Pump Enerpac | PUJ-1200B |
| 18 Set of 6 Interchangeable Ram Points | PH-5-3 |
| Set Includes: | |
| 1-Flat Ram Point .63 x 2.3 (16 x 59mm) | PH-5-1 |
| 1-Tapered Ram Point .63 x 2.4 (16 x 61mm) | PH-5-2 |

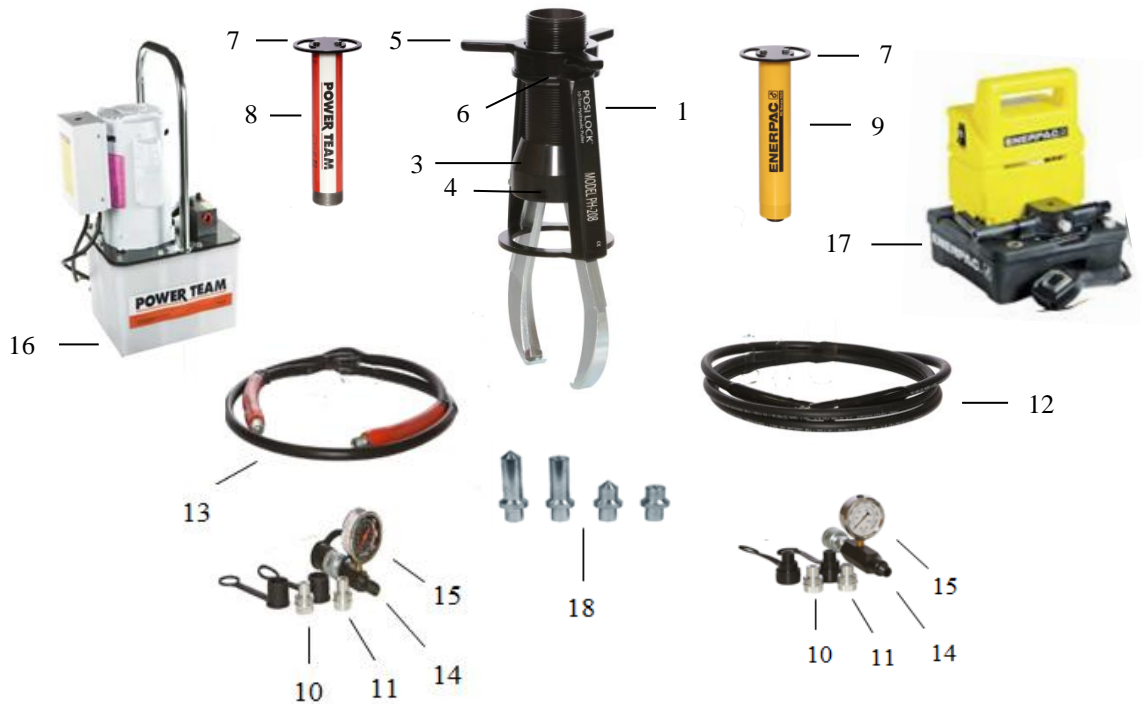

PHES-208 Consists of:

| Description | Part # |
|---|-----------|
| 1 Cage®- 2 Jaw | PH-20853 |
| 2 Jaw | 10854 |
| 3 Jaw Head Assembly | PH-20855 |
| 4 Pin | PH-10856 |
| 5 T-Handle | PH-10857 |
| 6 Snap Ring | PH-10859 |
| 7 Lift Plate | PH-11052 |
| 8 Power Team Cylinder | C106C |
| 9 Enerpac Cylinder | RC-106 |
| 10 Female Coupler | CR-400 |
| 11 Male Coupler | CH-604 |
| 12 10 ft. Heavy Duty Hose | PH-927 |
| 13 10 ft. Power Team Hose | 9785 |
| 14 Gauge Adapter | GA-3 |
| 15 Gauge (10,000 psi) | G2535L |
| 16 2 Stage Electric Pump Power Team | PE172 |
| 17 2 Stage Electric Pump Enerpac | PUJ-1200B |
| 18 Set of 6 Interchangeable Ram Points | PH-15-5 |
| Set Includes: | |
| 1-Flat Ram Point 1 x 1 (25 x 25mm) | PH-15-1 |
| 1-Flat Ram Point 1 x 3 (25 x 76mm) | PH-15-2 |
| 1-Tapered Ram Point 1 x 1.5 (25 x 38mm) | PH-15-3 |
| 1-Tapered Ram Point 1 x 3.5 (25 x 89mm) | PH-15-4 |

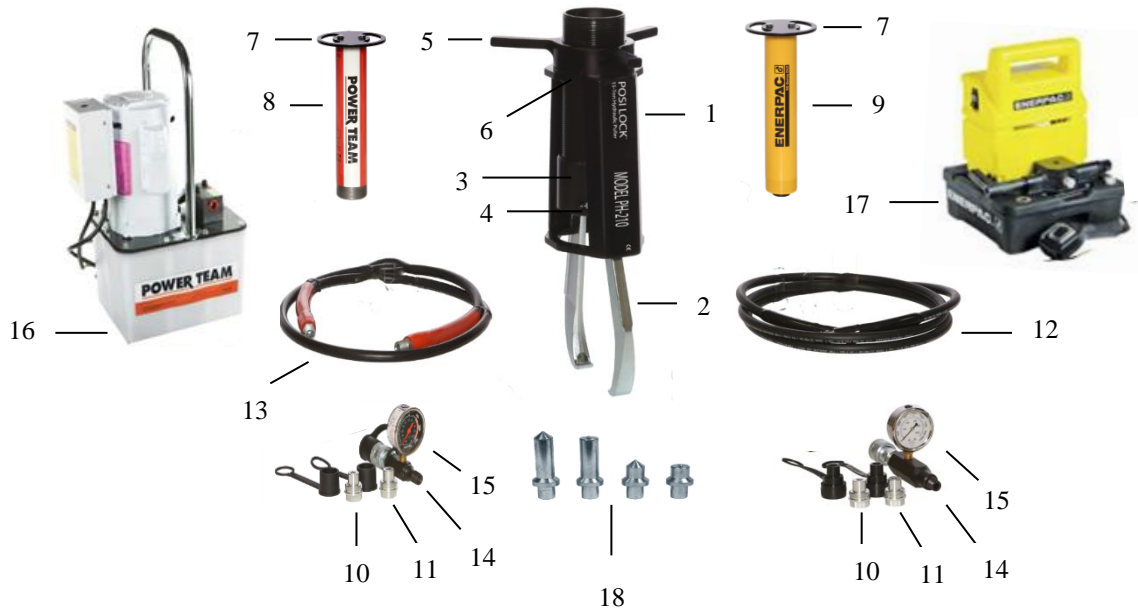

PHES-210 Consists of:

| Description | Part # |
|---|-----------|
| 1 Cage®- 2 Jaw | PH-21053 |
| 2 Jaw | PH-11054 |
| 3 Jaw Head Assembly | PH-21055 |
| 4 Pin | PH-11056 |
| 5 T-Handle | PH-11057 |
| 6 Snap Ring | PH-11059 |
| 7 Lift Plate | PH-11052 |
| 8 Power Team Cylinder | C1510C |
| 9 Enerpac Cylinder | RC-1510 |
| 10 Female Coupler | CR-400 |
| 11 Male Coupler | CH-604 |
| 12 10 ft. Heavy Duty Hose Posi Lock | PH-927 |
| 13 10 ft. Power Team Hose | 9785 |
| 14 Gauge Adapter | GA-3 |
| 15 Gauge (10,000 psi) | G2535L |
| 16 2 Stage Electric Pump Power Team | PE172 |
| 17 2 Stage Electric Pump Enerpac | PUJ-1200B |
| 18 Set of 6 Interchangeable Ram Points | PH-15-5 |
| Set Includes: | |
| 1-Flat Ram Point 1 x 1 (25 x 25mm) | PH-15-1 |
| 1-Flat Ram Point 1 x 3 (25 x 76mm) | PH-15-2 |
| 1-Tapered Ram Point 1 x 1.5 (25 x 38mm) | PH-15-3 |
| 1-Tapered Ram Point 1 x 3.5 (25 x 89mm) | PH-15-4 |



PHES-213 Consists of:

| Description | Part # |
|---|-----------|
| 1 Cage®- 2 Jaw | PH-21353 |
| 2 Jaw | 11354 |
| 3 Jaw Head Assembly | PH-21355 |
| 4 Pin | 11356 |
| 5 T-Handle | PH-11357 |
| 6 Snap Ring | PH-11359 |
| 7 Lift Plate | PH-11352 |
| 8 Power Team Cylinder | C2514C |
| 9 Enerpac Cylinder | RC-2514 |
| 10 Female Coupler | CR-400 |
| 11 Male Coupler | CH-604 |
| 12 10 ft. Heavy Duty Hose | PH-927 |
| 13 10 ft. Power Team Hose | 9785 |
| 14 Gauge Adapter | GA-3 |
| 15 Gauge (10,000 psi) | G2535L |
| 16 2 Stage Electric Pump Power Team | PE172 |
| 17 2 Stage Electric Pump Enerpac | PUJ-1200B |
| 18 Set of 6 Interchangeable Ram Points | PH-25-7 |
| Set Includes: | |
| 1-Flat Ram Point 1.5 x 2.25 (38 x 57mm) | PH-25-1 |
| 1-Flat Ram Point 2 x 2.25 (51 x 64mm) | PH-25-2 |
| 1-Flat Ram Point 2 x 4 (51 x 102mm) | PH-25-3 |
| 1-Tapered Ram Point 1.5 x 2.5 (38 x 64mm) | PH-25-4 |
| 1-Tapered Ram Point 2 x 2.5 (51 x 64mm) | PH-25-5 |
| 1-Tapered Ram Point 2 x 4.5 (51 x 114mm) | PH-25-6 |
| 19 Storage Transport Cart | PT-2550 |

Алматы (7273)495-231
 Архангельск (8182)63-90-72
 Астрахань (8512)99-46-04
 Барнаул (3852)73-04-60
 Белгород (4722)40-23-64
 Брянск (4832)59-03-52
 Владивосток (423)249-28-31
 Волгоград (844)278-03-48
 Вологда (8172)26-41-59
 Воронеж (473)204-51-73
 Екатеринбург (343)384-55-89
 Иваново (4932)77-34-06

Ижевск (3412)26-03-58
 Иркутск (395)279-98-46
 Казань (843)206-01-48
 Калининград (4012)72-03-81
 Калуга (4842)92-23-67
 Кемерово (3842)65-04-62
 Киров (8332)68-02-04
 Краснодар (861)203-40-90
 Красноярск (391)204-63-61
 Курск (4712)77-13-04
 Липецк (4742)52-20-81

Магнитогорск (3519)55-03-13
 Москва (495)268-04-70
 Мурманск (8152)59-64-93
 Набережные Челны (8552)20-53-41
 Нижний Новгород (831)429-08-12
 Новокузнецк (3843)20-46-81
 Новосибирск (383)227-86-73
 Омск (3812)21-46-40
 Орел (4862)44-53-42
 Оренбург (3532)37-68-04
 Пенза (8412)22-31-16

Пермь (342)205-81-47
 Ростов-на-Дону (863)308-18-15
 Рязань (4912)46-61-64
 Самара (846)206-03-16
 Санкт-Петербург (812)309-46-40
 Саратов (845)249-38-78
 Севастополь (8692)22-31-93
 Симферополь (3652)67-13-56
 Смоленск (4812)29-41-54
 Сочи (862)225-72-31
 Ставрополь (8652)20-65-13

Сургут (3462)77-98-35
 Тверь (4822)63-31-35
 Томск (3822)98-41-53
 Тула (4872)74-02-29
 Тюмень (3452)66-21-18
 Ульяновск (8422)24-23-59
 Уфа (347)229-48-12
 Хабаровск (4212)92-98-04
 Челябинск (351)202-03-61
 Череповец (8202)49-02-64
 Ярославль (4852)69-52-93

Киргизия (996)312-96-26-47

Россия (495)268-04-70

Казахстан (7172)727-132